

LEGEND

	Full Planning Application Boundary		Existing trees & scrub adjacent to & within site to be retained
	Pedestrian routes/ areas		Proposed tree planting
	Tarmac: car and coach parking, running lanes (tar spray/ chip annotated) and key paths		Mown grass
	Stone reinforcement		Wildflower areas
	Basalt or similar (well rolled and firm)		Native and ornamental shrubs (see planting proposals)
	Quality Surface treatments (Addastone or Tar spray/ chip) Includes Snake pattern.		Fencing and handrails
	Proposed Gabions / retaining walls		Seating
	Ditch or water course as annotated		Interpretation Proposed locations
	2012 amended public right of way		Artistic silhouettes (cross) and columns (blue)
	Pre-2012 public right of way		Fingerposts
	Steep slopes/ banks and Existing Contours (dashed line)		Lighting bollards
	Barrier Gates		Bollards
	New access points to DZG, BCLM & DCT		Cycle shelter
	Proposed Monolith Sign		Animal sculptures

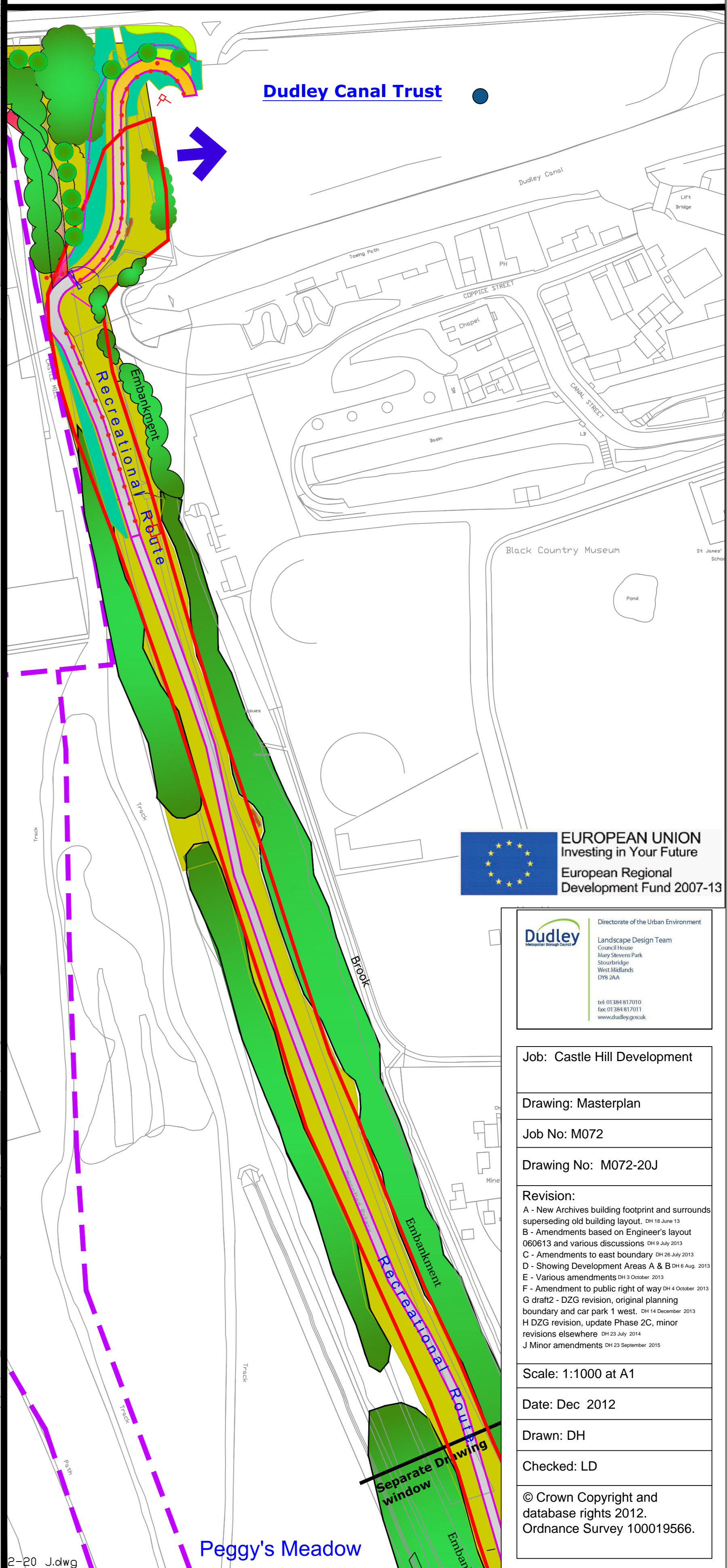

Directorate of the Urban Environment
 Landscape Design Team
 Council House
 May Street, Park
 Stourbridge
 West Midlands
 DY9 9JA
 Tel: 01825 877010
 Fax: 01825 877011
 www.dubey.gov.uk

Job: Castle Hill Development
 Drawing: Masterplan
 Job No: M072
 Drawing No: M072-20J
 Revision:
 A - New Archives building footprint and surrounds superseding old building layout. 01/10/2013
 B - Amendments based on Engineer's layout 06/06/13 and various discussions. 01/10/2013
 C - Amendments to east boundary. 01/10/2013
 D - Showing Development Areas A & B. 01/10/2013
 E - Various amendments. 01/10/2013
 F - Amendment to public right of way. 01/10/2013
 G draft2 - DZG revision, original planning boundary and car park 1 west. 01/10/2013
 H DZG revision, update Phase 2C, minor revisions elsewhere. 01/10/2013
 J Minor amendments. 01/10/2013
 Scale: 1:1000 at A1
 Date: Dec 2012
 Drawn: DH
 Checked: LD
 © Crown Copyright and database rights 2012. Ordnance Survey 100019566.